

VTR-A-3323 Square Trimming Potentiometer

Single Turn/ Cermet/ Industrial/ Sealed * 7 Terminal Styles

| Electrical Characteristics | | Environmental Characteristics | |
|------------------------------|--|-------------------------------|--|
| Standard Resistance Range | 10Ω - 5MΩ | Power Rating (max 315V) | 0.75W@70°C, 0W@125°C |
| Resistance Tolerance | ±10% | Temperature Range | -55°C ~ +125°C |
| Absolute Minimum Resistance | ≤10Ω(100Ω≤R≤1K Ω) | Temperature Coefficient | 200 or ±100ppm/°C |
| Resistance | ≤1%R (R>1K Ω) | Temperature Variation | -55°C, 30min, +125°C 30min, 5 cycles |
| Contact Resistance Variation | CRV≤3% or 5 Ω | | ΔR≤5%R, Δ(Uab/Uac)≤5% |
| Insulation Resistance | R1≥1GΩ(500Vac) | Vibration | 10 – 500Hz, 0.75mm, 6h ΔR≤5%R, Δ(Uab/Uac)≤7.5% |
| Withstand Voltage | 220V | Collision | 390m/s ² , 4000cycles, ΔR≤5%R |
| Effective Travel | 270°± 10° | Electrical Endurance at 70°C | 0.75W@70°C 1000h, ΔR≤5%R CRV≤4% or 5 Ω (whichever is larger) |
| Physical Characteristics | | Rotational Life | 200 cycles (whichever is larger) ΔTR≤10%R, CRV≤3% or 5 Ω |
| Starting Torque | ≤35mN·m | | |
| Marking | Resistance Tolerance Model Resistance Code | | |
| Standard Packaging | 50pcs, per tube | | |

Common Dimensions Top Adjust

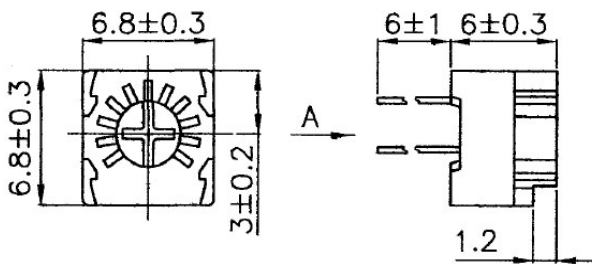

How To Order

VTR-A-3323P-103-R

Model _____

Style _____

Resistance _____

RoHS _____

VTR-A-3323P

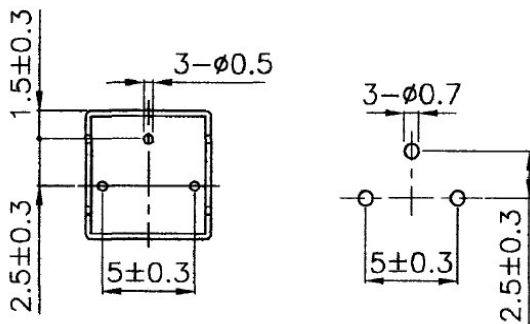

VTR-A-3323C

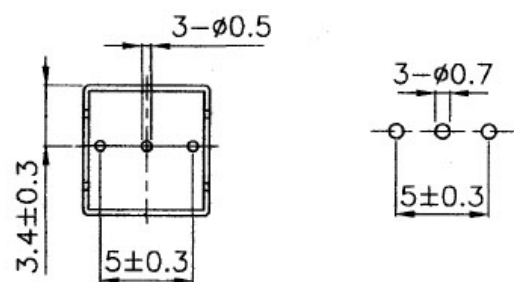

VTR-A-3323R

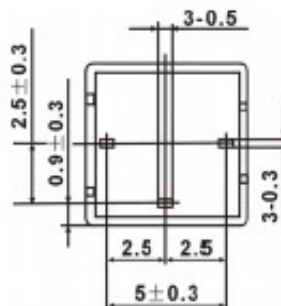

VTR-A-3323 Square Trimming Potentiometer

Single Turn/ Cermet/ Industrial/ Sealed * 7 Terminal Styles

Side Adjust

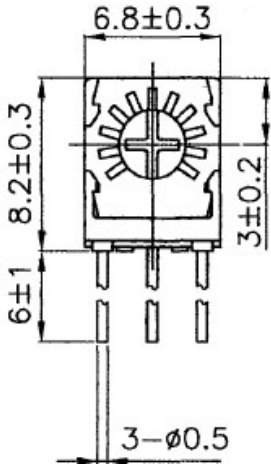

VTR-A-3323S

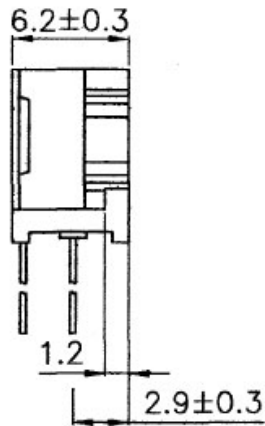
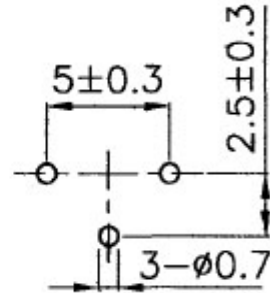
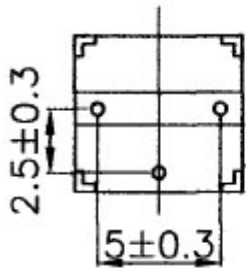

VTR-A-3323W

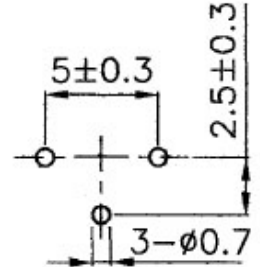
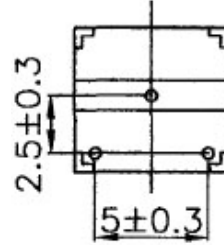

VTR-A-3323V

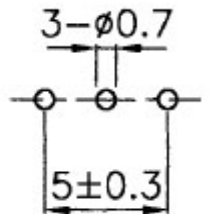
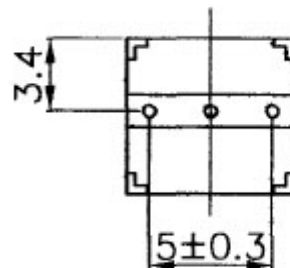

VTR-A-3323D (Rear Adjust)

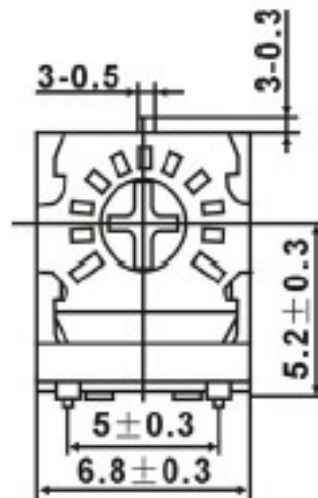
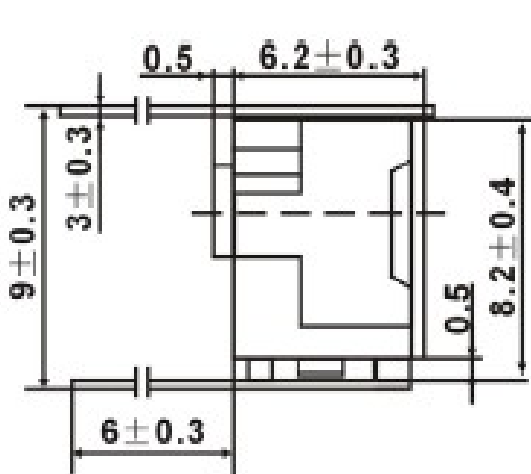

Note: Specification are subject to change without notice. For more updated information, please visit our website.